

# Installation Instructions

## Camus Chandelier

### Important Safety Instructions

- Turn off all power to the Junction Box before making any electrical adjustments.
- Always disconnect the power before installing/replacing bulbs, during cleaning or maintenance.
- To avoid the risk of fire, do not exceed the recommended wattage.
- Consult a qualified, licensed electrician before installation.

### To Assemble

1. Install the Mounting Disc to the Junction Box using the supplied mounting screw hardware. Confirm J-Box weight capacity can hold the chandelier (95lbs).
2. Confirm the top brass loop is screwed to the ceiling plate and fastened through the chain assembly.
3. Loop the chain assembly to the chandelier body using the removable chain link and a screw driver. Feed the black cord through every other chain link until it reaches the canopy.
4. Hold the ceiling plate next to the J-Box, and connect the wires to those in the J-box using the Wago wire connectors.
5. Push the ceiling plate over the mounting disc, flush with the ceiling and screw on both finials (2X).
6. Screw in each bulb (4X).  
\*DO NOT OVER TIGHTEN THE BULBS\*
7. Observe that some of the crystal panels have a corner cutout. Align those properly to fit along the upper half of the cube. Slide the panels over each standoff and tighten with the supplied caps (12X).
8. Turn on the power to confirm you have made good wire connections.

### Care Instructions

- Wipe with a soft cloth. Do not use chemical cleaner.

\*We recommend installation by a licensed electrician

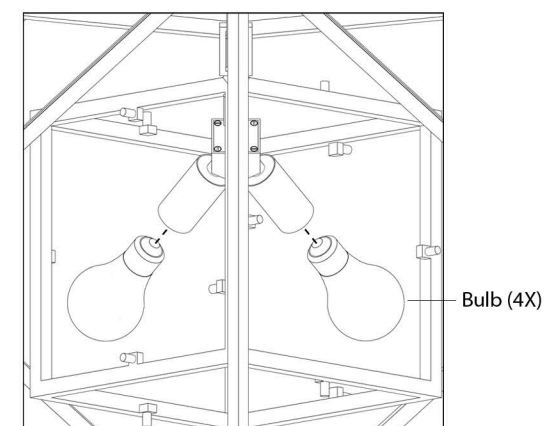
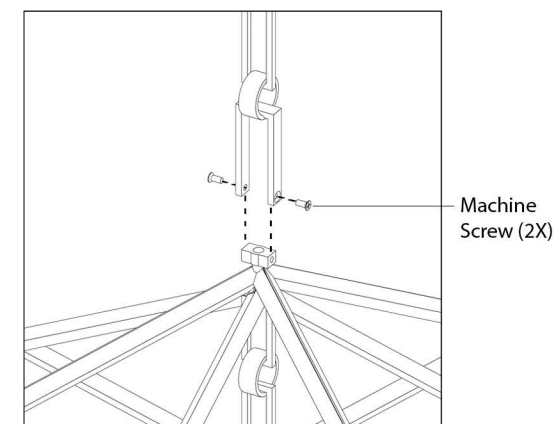
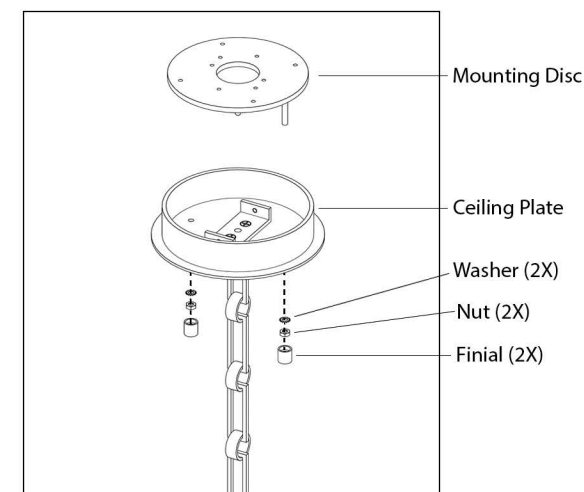
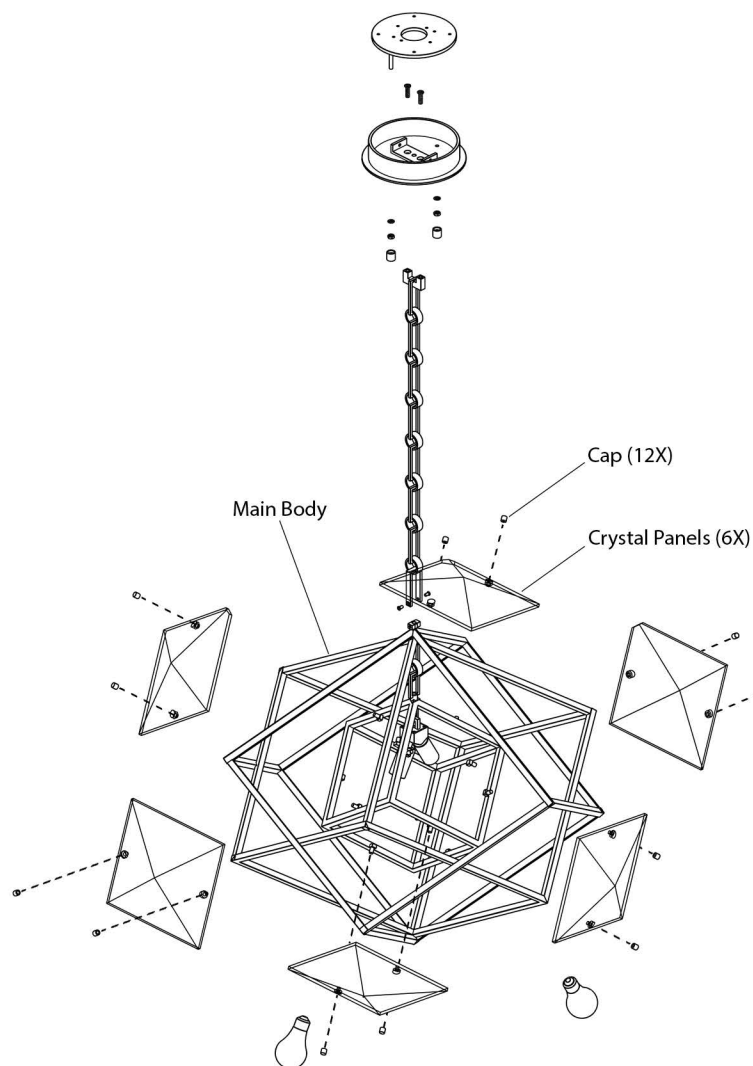

Electrical: 4 x E26 8W LED Bulb only