

# Installation Instructions

## Chamont Flushmount

### Important Safety Instructions

- Turn off all power to the Junction Box before making any electrical adjustments.
- Always disconnect the power before installing/replacing bulbs, during cleaning or maintenance.
- To avoid the risk of fire, do not exceed the recommended wattage.
- Consult a qualified, licensed electrician before installation.

### To Assemble

1. Position the Etched Glass and Frosted Diffuser into the Lower Ring.
2. Use the Slotted Machine Screws (8X) to fasten the Lower Ring and Upper Ring into the posts. We recommend one person holds the glass steady while another person fastens each screw.
3. Using the supplied wire nuts, connect the wires from the Mounting Disc Assembly to those in the J-box.
4. Use the supplied Mounting Screws (4X) to fasten the Mounting Disc Assembly to the J-Box.
5. Screw in each light bulb (2X). Do not overtighten.
6. Remove the each set screw (3X) at the 120° position on the Upper Ring.
7. Push the Flushmount Assembly over the Mounting Disc Assembly, flush with the ceiling and tighten the each set screw (3X).
8. Turn on the power to ensure you have made good wire connections.

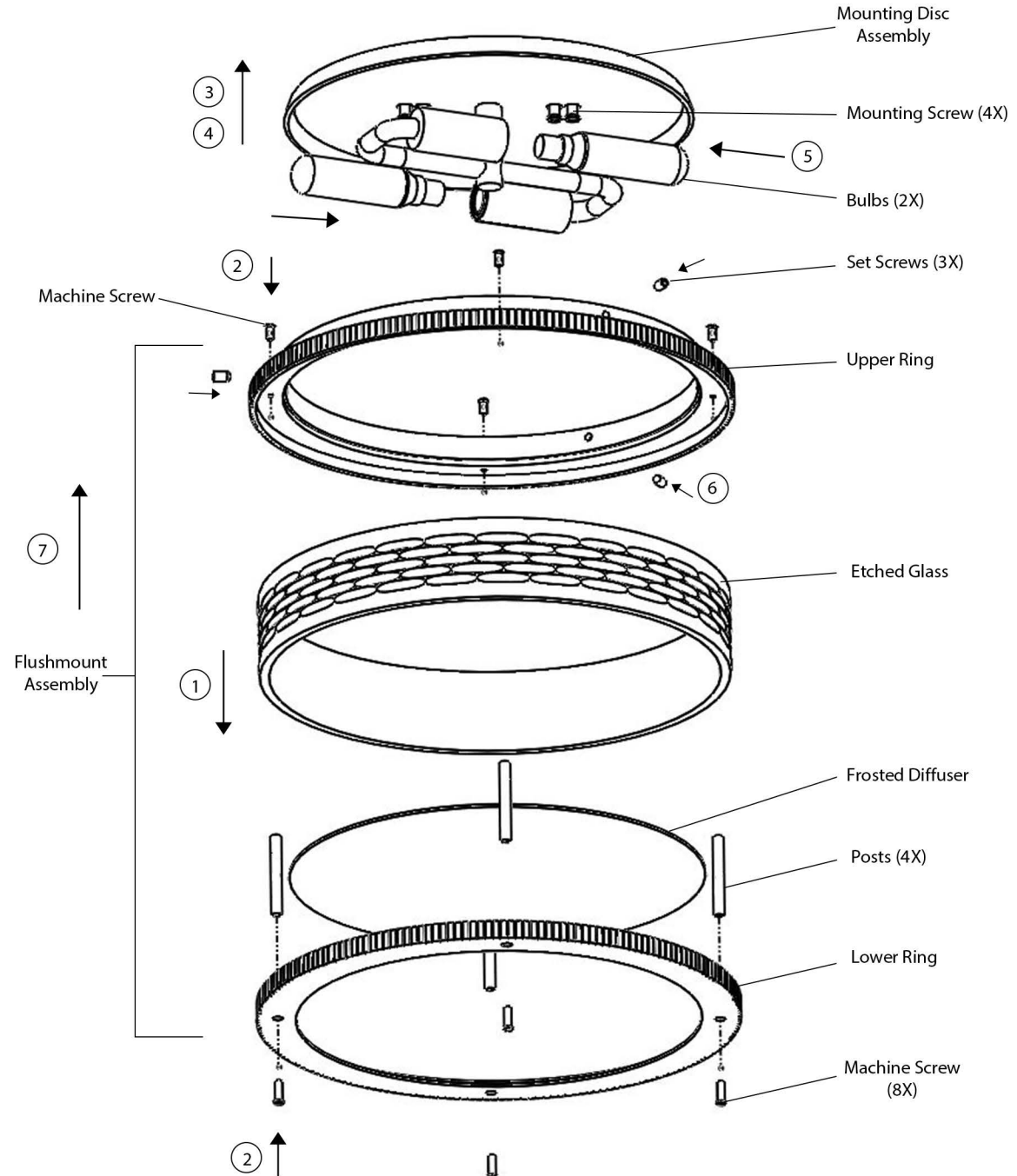

\*We recommend installation by a licensed electrician

Electrical: 2 x E12 4W LED Only