

# Installation Instructions

## Duvernois Floor Lamp

### Important Safety Instructions

- Turn off all power to the Junction Box before making any electrical adjustments.
- Always disconnect the power before installing/replacing bulbs, during cleaning or maintenance.
- To avoid the risk of fire, do not exceed the recommended wattage.
- Consult a qualified, licensed electrician before installation.

### To Assemble

1. Carefully push the floor plate assembly over the threaded stem and tighten with the provided nut and washers. \*Only hand tighten\*. Tighten the set screw to secure the nut.
2. Remove the threaded socket cover and slide the frosted shade over the socket platform. Tighten with the threaded socket cover to secure the shade.
3. Install the bulb. \*DO NOT OVER TIGHTEN THE BULBS\*
4. Carefully slide the fins assembly over the frosted shade.

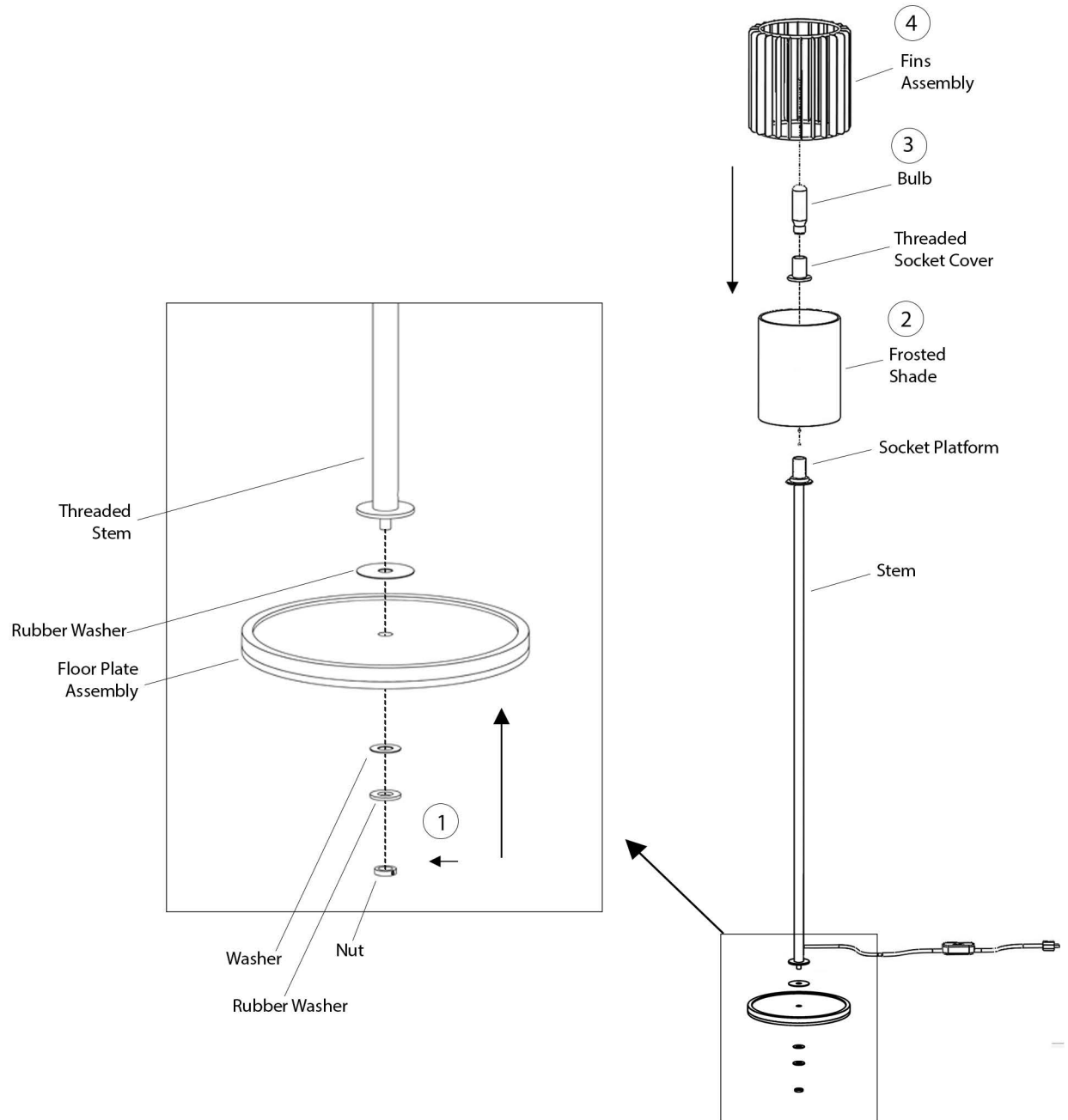

### Care Instructions

- Wipe with a soft cloth. Do not use chemical cleaner.

\*We recommend installation by a licensed electrician

Electrical: 1 x E26 6W LED bulb only