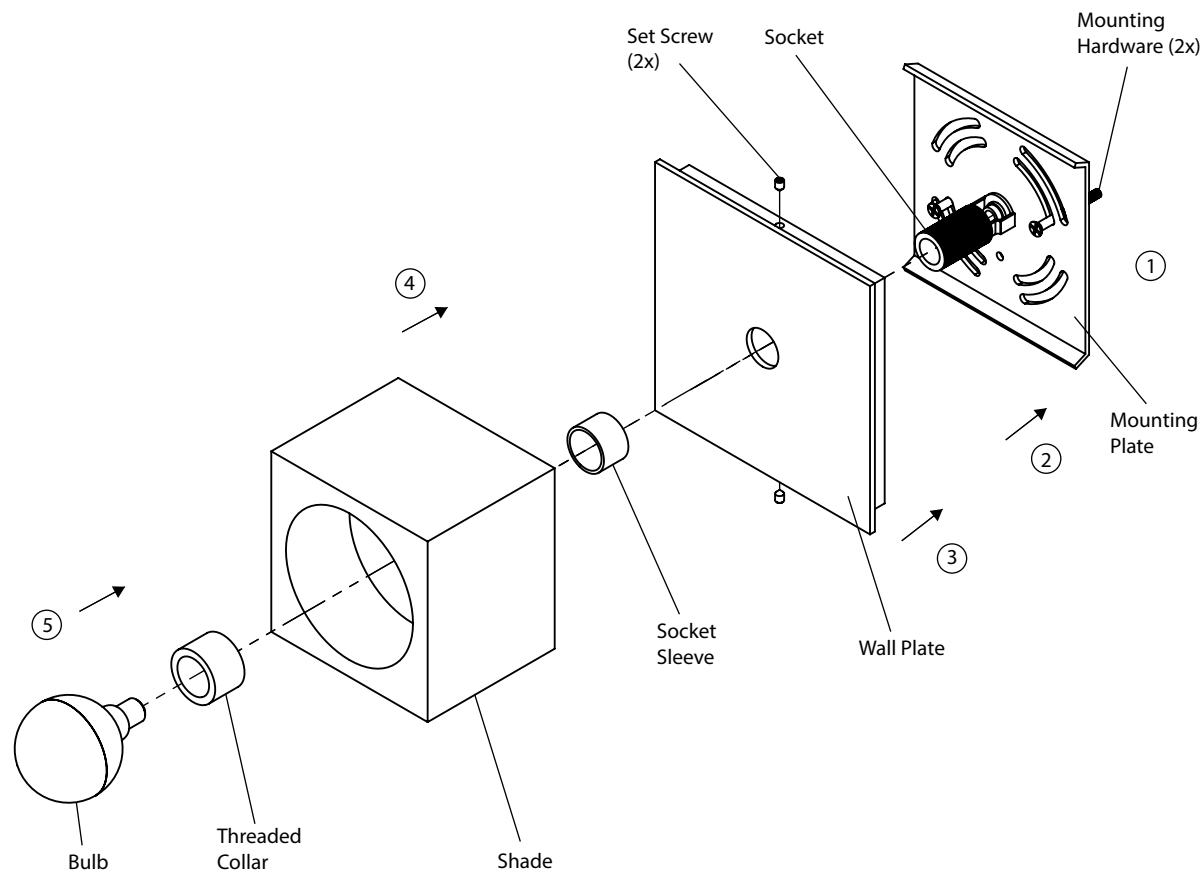

**Important Safety Instructions**

- Turn off all power to the Junction Box before making any electrical adjustments.
- Always disconnect the power before installing/replacing bulbs, during cleaning or maintenance.
- To avoid the risk of fire, do not exceed the recommended wattage.
- Consult a qualified, licensed electrician before installation.

**To Assemble**

1. Hold the mounting plate near the junction box, and using the supplied lever nuts, connect the wires from the fixture to those in the J-box.
2. Install the mounting plate to the junction box using the supplied machine screw hardware (2x).
3. Slide the wall plate over the socket and tighten each set screw (2x).
4. Hold the Socket Sleeve over the socket, slide over the Glacon shade, and secure it using the threaded collar.
5. Install the mirrored light bulb. **\*DO NOT OVERTIGHTEN\***.
6. Turn on the power and check that good connections have been made.

**Care Instructions**

- Wipe with a soft cloth. Do not use chemical cleaner.