

Important Safety Instructions

- Turn off all power to the Junction Box before making any electrical adjustments.
- Always disconnect the power before installing/replacing bulbs, during cleaning or maintenance.
- To avoid the risk of fire, do not exceed the recommended wattage.
- Consult a qualified, licensed electrician before installation.

To Assemble

1. Install the beveled mounting disc to the Junction-Box using the supplied machine screw hardware (2X).
2. Hold the sconce next to the J-Box, and connect the wires to those in the J-box using the wire nuts.
3. Remove the set screws (2x) at the 12:00 and 6:00 positions on the sconce wall plate and press the sconce over the mounting disk, flush with the wall.
4. Level the sconce and tighten the set screw to finalize the installation of the sconce body.
5. Install the back crystal on the sconce body and secure it with the top cap. Then, install all the standoffs onto the back crystal and secure them using the caps. Align the front crystal with the back crystal and standoffs and secure it using the remaining caps starting from the top cap as shown in Figure 1. Do not overtighten the cap.
6. Screw in the supplied light bulb and turn on the power to confirm you have made good wire connections.

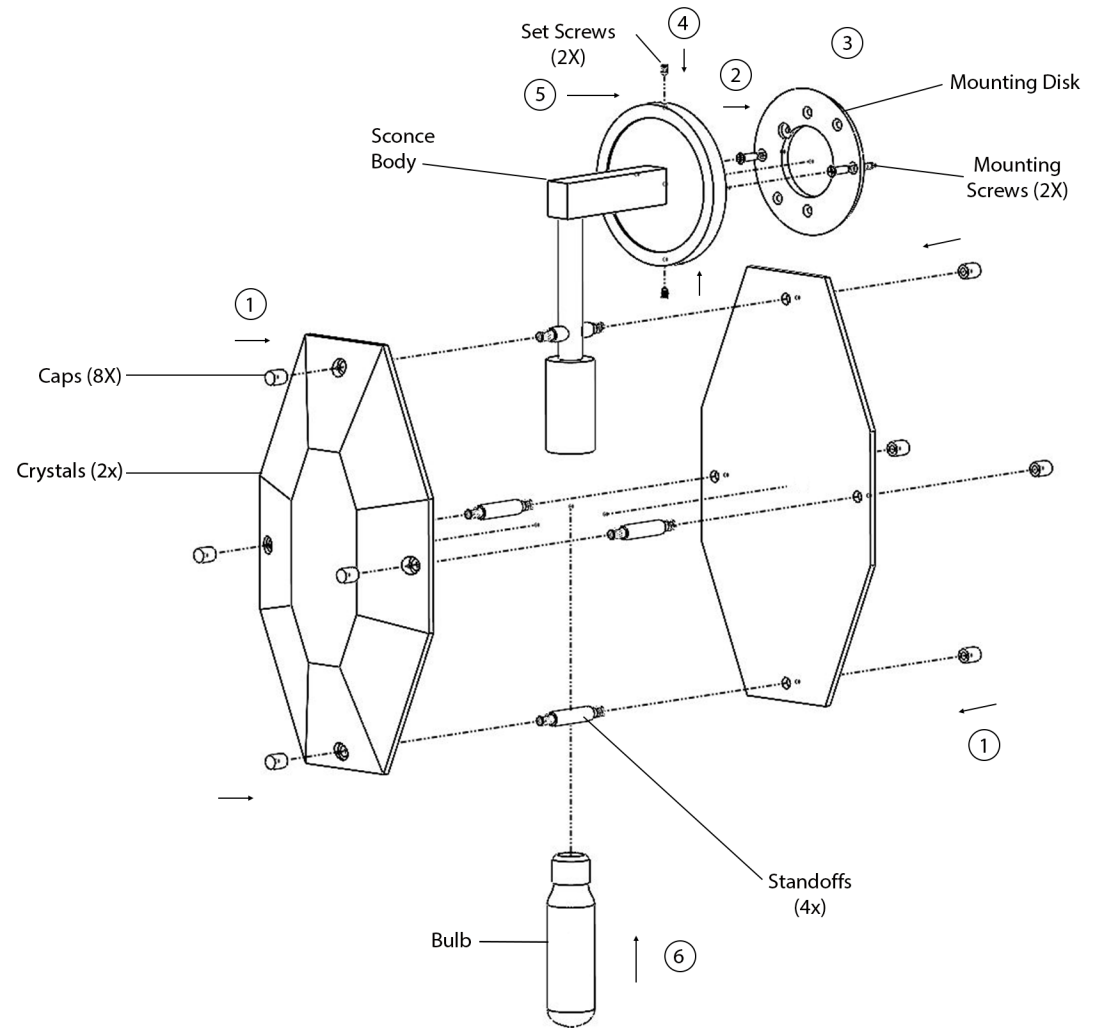

Figure 1

Care Instructions

- Wipe with a soft cloth. Do not use chemical cleaner.