

Installation Instructions

Leclerc Outdoor Sconce

Important Safety Instructions

- Turn off all power to the Junction Box before making any electrical adjustments.
- Always disconnect the power before installing/replacing bulbs, during cleaning or maintenance.
- To avoid the risk of fire, do not exceed the recommended wattage.
- Consult a qualified, licensed electrician before installation.

To Assemble

1. Install the beveled mounting plate to the J-box using the supplied mounting screw hardware (2X).
2. Hold the wall plate next to the J-Box, and connect the wires to those in the J-box using the Wago wire connectors.
3. Loosen the set screws (4X) and press the sconce over the mounting disc, flush with the wall and tighten each set screw (4X).
4. Push in the bulbs (2X).
5. Slide each glass cover (2X) over the installed bulb and screw into place.
6. Turn on the power to confirm you have made good wire connections.

If required in your location, install the dark sky compliant top cover by screwing in the two provided screws

Care Instructions

- Wipe with a soft cloth. Do not use chemical cleaner.

*We recommend installation by a licensed electrician

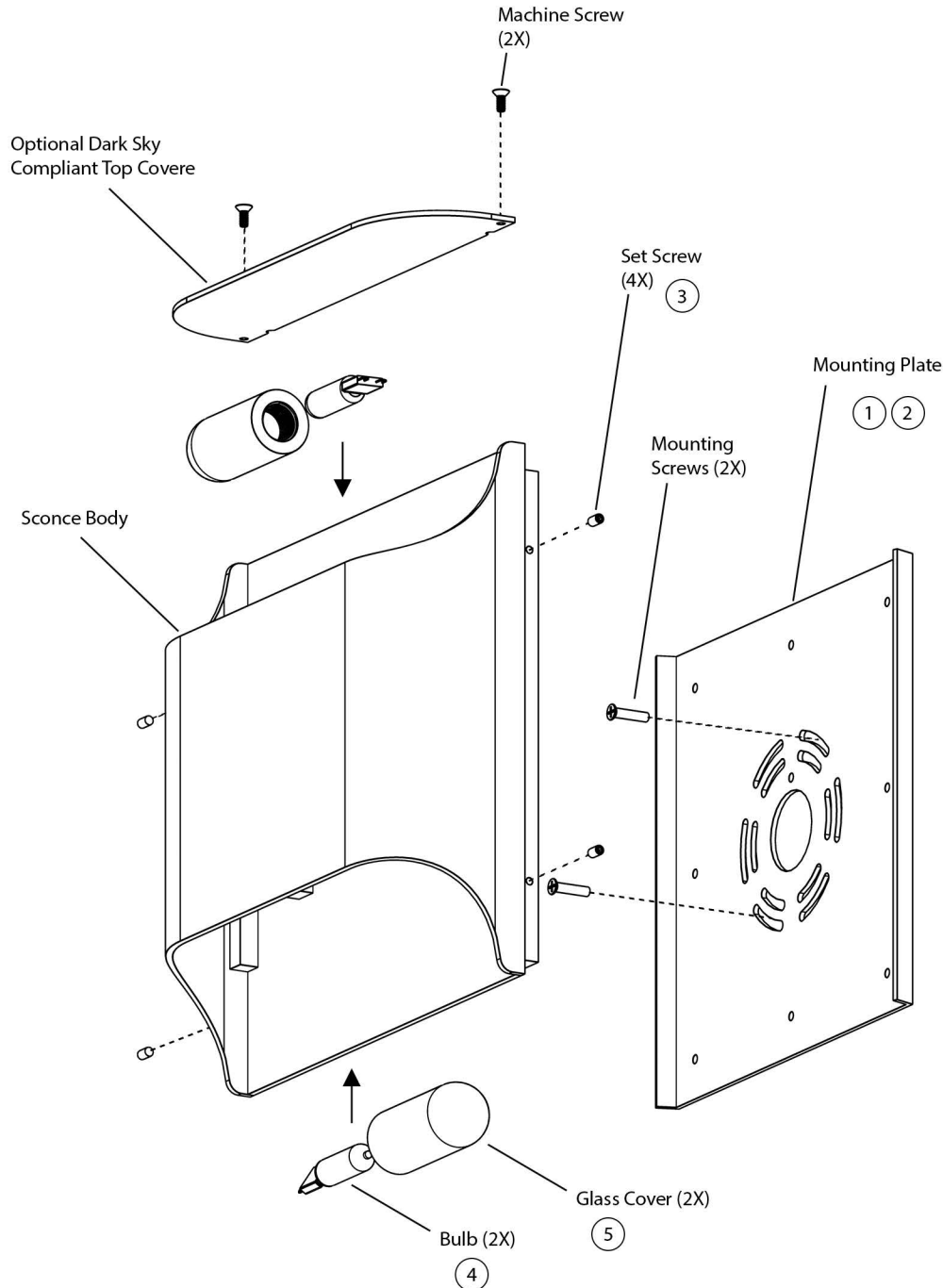

Electrical: 2 x G9 3.5W LED bulb only