

Installation Instructions

Ambrault Table Lamp

Important Safety Instructions

- Turn off all power to the Junction Box before making any electrical adjustments.
- Always disconnect the power before installing/replacing bulbs, during cleaning or maintenance.
- To avoid the risk of fire, do not exceed the recommended wattage.
- Consult a qualified, licensed electrician before installation.

To Assemble

1. Gently lift the lamp body out of the packaging and place on protected surface.
2. Slide the shade over the socket cover and position it onto the lamp body. Ensure proper alignment, then secure it in place using the provided thumb screws.
3. Screw in the bulb. *Do not over-tighten the bulb.*
4. Plug in the cord and rotate the dimmer knob to confirm the bulb is getting power.

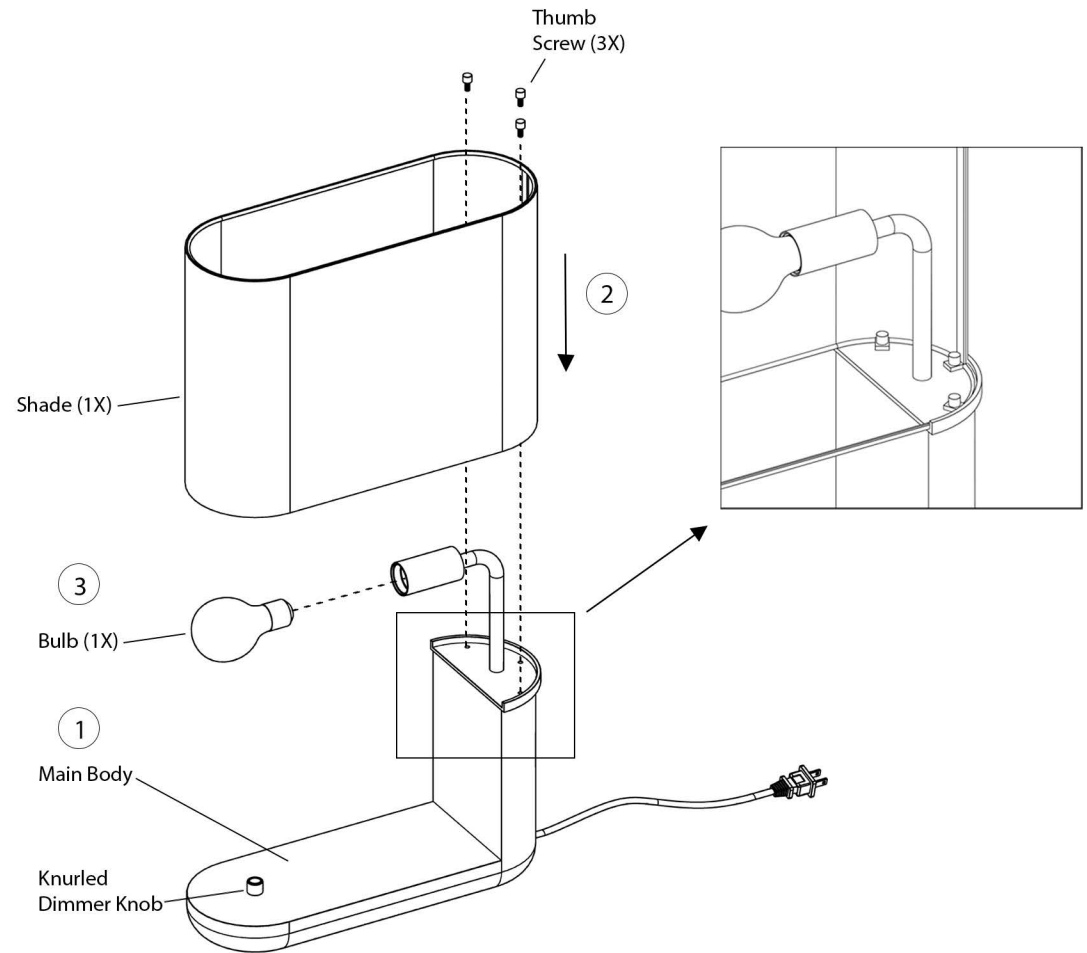

Care Instructions

- Wipe with a soft cloth. Do not use chemical cleaner.