

Important Safety Instructions

- Turn off all power to the Junction Box before making any electrical adjustments.
- Always disconnect the power before installing/replacing bulbs, during cleaning or maintenance.
- To avoid the risk of fire, do not exceed the recommended wattage.
- Consult a qualified, licensed electrician before installation.

To Assemble

1. Install the beveled mounting disc to the J-box using the supplied machine screw hardware (2X).
2. Feed the electrical wires through the all thread. Then, attach the all thread to the main body and slide the drop rod over it, and flush with the main body.
3. Secure the all thread by tightening the set screw on the main body.
4. Slide the ceiling plate over the all threads and tighten the washers and nuts using a wrench.
5. Hold the ceiling plate near the installed mounting plate, and using the supplied lever nuts, connect the wires from the fixture to those in the J-box.
6. Loosen each set screw (3X) at the 120° position on the pendant ceiling plate.
7. Push the ceiling plate over the mounting disc, flush with the ceiling, and tighten each set screw (3X).
8. Install 4x standoff to the main body using 4x thumb screws from inside as shown. Then, secure the inner shade to the main body by screwing in the threaded ring.
9. Slide the outer shade over the main body and secure it using the 4x thumb screws onto the 4x standoffs.
10. Screw in the bulb. *Do not over-tighten the bulb.*
11. Turn on the power to confirm you have made a good wire connection.

Care Instructions

- Wipe with a soft cloth. Do not use chemical cleaner.

*We recommend installation by a licensed electrician

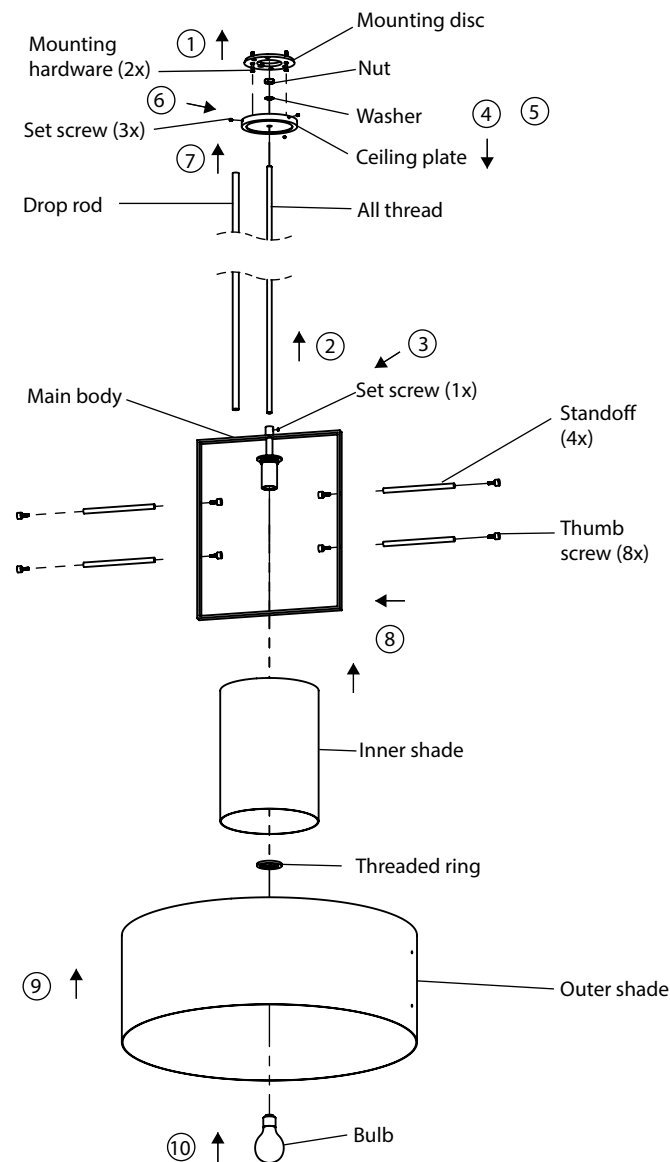

Electrical: 1 x E26 A19 12W - LED bulb only