

Installation Instructions

Lemonnier Flush Mount

Important Safety Instructions

- Turn off all power to the Junction Box before making any electrical adjustments.
- Always disconnect the power before installing/replacing bulbs, during cleaning or maintenance.
- To avoid the risk of fire, do not exceed the recommended wattage.
- Consult a qualified, licensed electrician before installation.

To Assemble

1. Set the body sub-assembly on a flat surface, and remove the top ring by unscrewing 4x large screws.
2. Place glass shade (27x) into the slot on the bottom ring and align the top ring slot to the glass shades and slide it over the glass shades. Align the 4x studs on the bottom ring with the screw holes in the top ring. Screw in the 4x large screws to secure it properly.
3. Slide the frosted glass panel through the top ring, place it at the bottom ring ledge, and secure it with a 4x tab using a screw (4x).
4. Install the beveled mounting disc to the J-box using the supplied machine screw hardware (2x). Additional holes are added to the mounting plate for extra mounting screw hardware (not provided). Anchors or ceiling blocking is strongly advised.
5. Hold the socket platform near the installed mounting plate, and using the supplied lever nuts, connect the wires from the fixture to those in the J-box.
6. Secure the socket platform using a thumb screw (3x) and screw in the bulbs (3x). *Do not over-tighten the bulb.*
7. Remove each set screw (3x) at the 120° position on the top ring. Push the body sub- assembly over the mounting disc, flush with the ceiling, and tighten each set screw (3X).
8. Turn on the power to confirm you have made a good wire connection.

Care Instructions

- Wipe with a soft cloth. Do not use chemical cleaner.

*We recommend installation by a licensed electrician

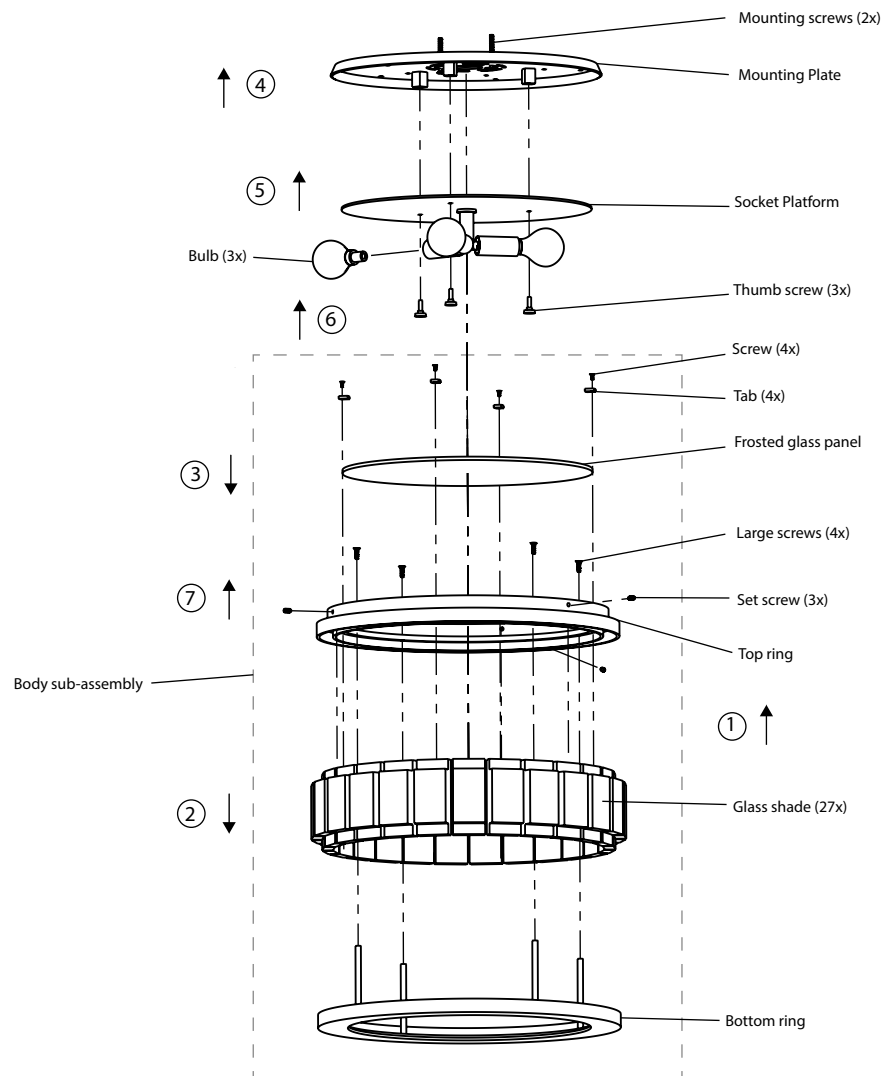

Electrical: 3 x E12 4W G45 LED Bulb Only