

Installation Instructions

Dessay Linear Chandelier

Important Safety Instructions

- Turn off all power to the Junction Box before making any electrical adjustments.
- Always disconnect the power before installing/replacing bulbs, during cleaning or maintenance.
- To avoid the risk of fire, do not exceed the recommended wattage.
- Consult a qualified, licensed electrician before installation.

To Assemble

1. Install the beveled mounting disc to the J-box using the supplied machine screw hardware (2X).
2. Feed the electrical wires through the all thread. Then, attach the all thread to the main body and slide the drop rod over it, flush with the main body.
3. Secure the all thread by tightening the set screw on the main body.
4. Slide the ceiling plate over the all threads and tighten the nut and washer using a wrench.
5. Loosen each set screw (3X) at the 120 position on the chandelier ceiling plate.
6. Lift the entire chandelier and hold the ceiling plate near the installed mounting disc, and using the supplied lever nuts, connect the wires from the fixture to those in the J-box.
7. Push the ceiling plate over the mounting disc, flush with the ceiling, and tighten each set screw (3X).
8. Screw in the bulb (8X). *Do not over-tighten the bulb.*
9. Slide the shade (8X) in the shade holder and secure it using Thumb Screw (8X).
10. Turn on the power to confirm you have made good wire connection.

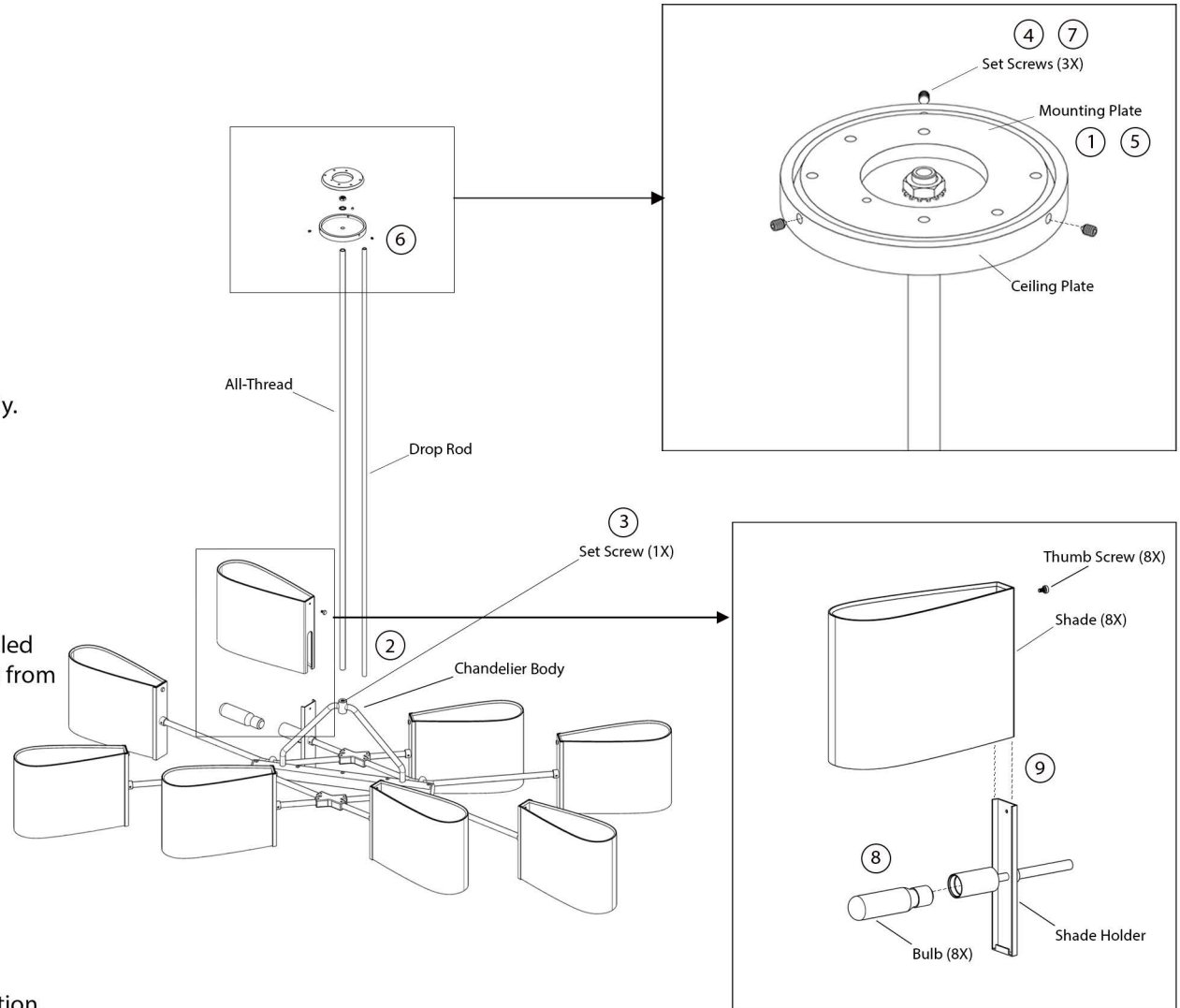

Care Instructions

- Wipe with a soft cloth. Do not use chemical cleaner.