

Installation Instructions

Voltaire Mobile Chandelier

Important Safety Instructions

- Turn off all power to the Junction Box before making any electrical adjustments.
- Always disconnect the power before installing/replacing bulbs, during cleaning or maintenance.
- To avoid the risk of fire, do not exceed the recommended wattage.
- Consult a qualified, licensed electrician before installation.

To Assemble

Step 1: Unpack and Prepare

Open the packaging and remove all items. Place all components on a protected surface to prevent damage.

Step 2: Assemble the Pendants

Assemble each of the three pendants on the protected surface.

Attach the shades by sliding the porcelain shade (18X) over the socket cover and secure it by screwing in the threaded ring on the socket cover using the provided tool (see Figure 2).

Screw the bulb (18X) into the socket.

Thread the all-thread into the body of the pendant and secure it using the set screw (see Figure 1).

Slide the tubing cover over the all-thread. There should be 1/2" of threads showing above the tubing. If not, adjust the all-thread by loosening the set screw.

Repeat this process for all three pendants.

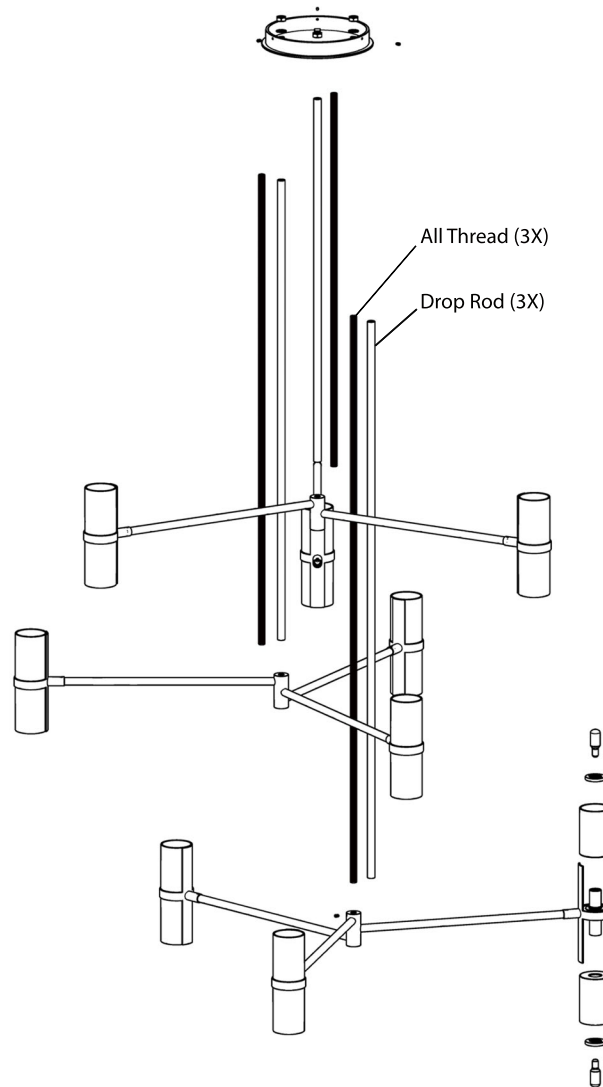

Figure 1

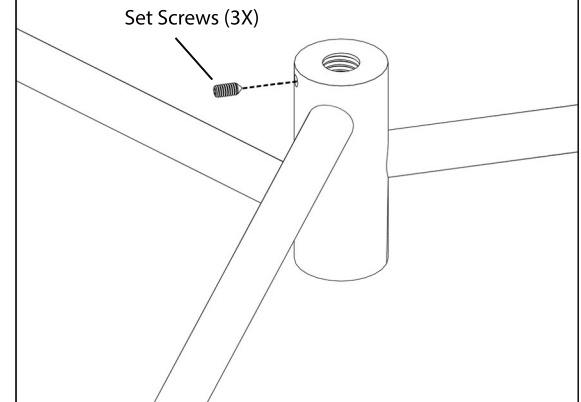
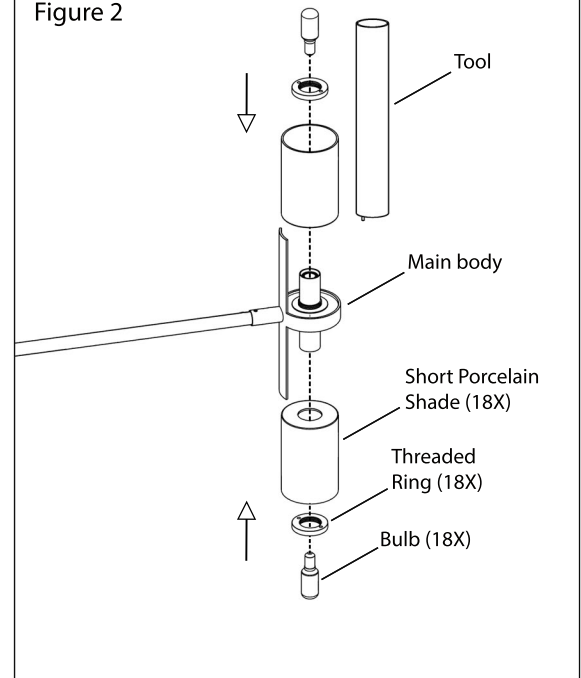

Figure 2



Installation Instructions

Voltaire Mobile Chandelier

Step 3: Choose an Installation Method

Select one of the two installation options before proceeding:

Option 1: Using Temporary Support (recommended option)

Gather two pieces of lumber (minimum length: 10 feet) and two ladders. Place a padded surface on the lumber to prevent scratches and rest the canopy on the lumber so that all three holes are visible from below.

Option 2: Direct Installation

If lumber is unavailable, install the mounting disc directly to the final j-box location. Mount the mounting disc using the provided hardware and hang the canopy using the carabiners (see Figure 3).

Step 4: Install the Pendants

Begin by installing the shortest pendant, followed by the middle-length pendant, and lastly, the longest pendant (orientation shown on page 3).

Secure each pendant to the hanging canopy by using the supplied lock washers and nuts.

Step 5: Attach the Fixture

Once all pendants are attached to the ceiling plate, raise the fixture to the mounting point at the junction box. Make all wire connections, then secure the canopy using the provided set screws (3X).

Turn on the power to confirm you have made good wire connections.

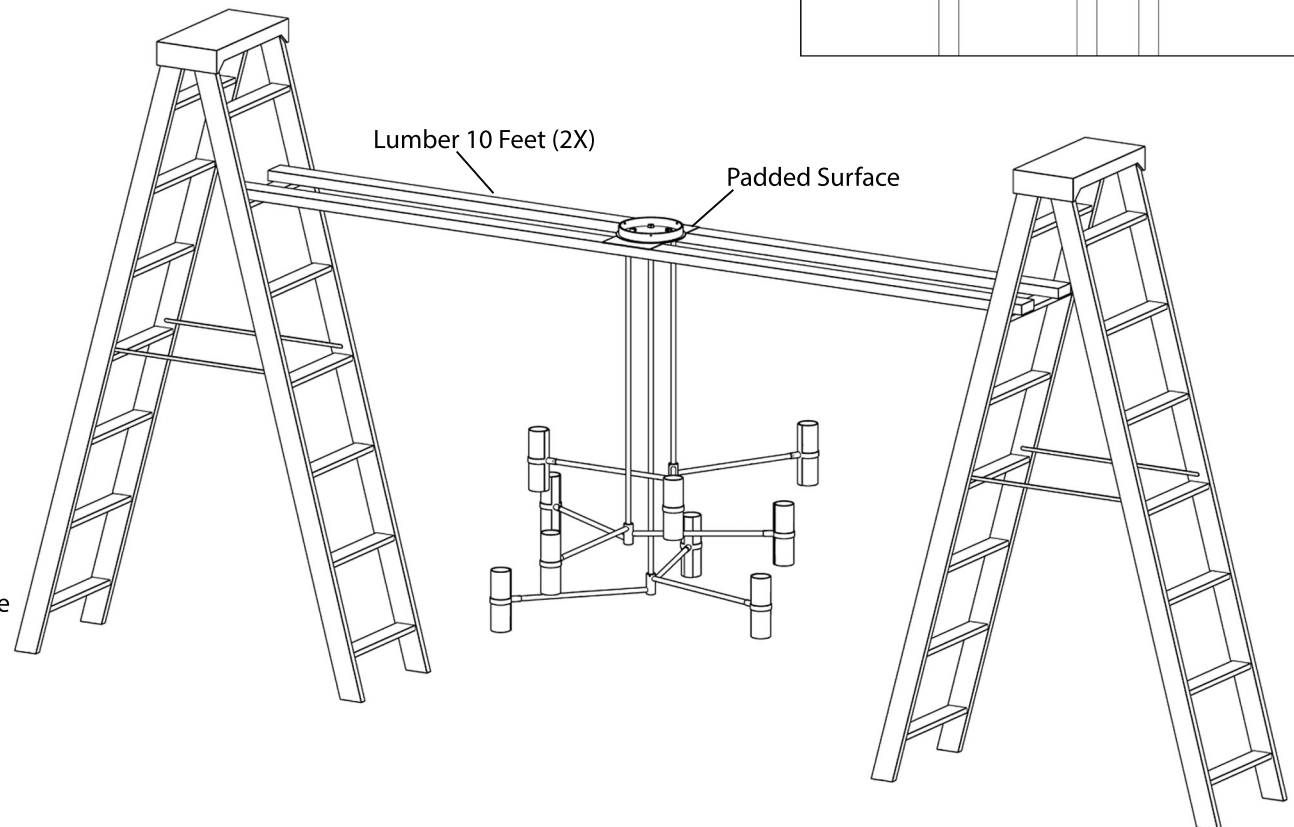
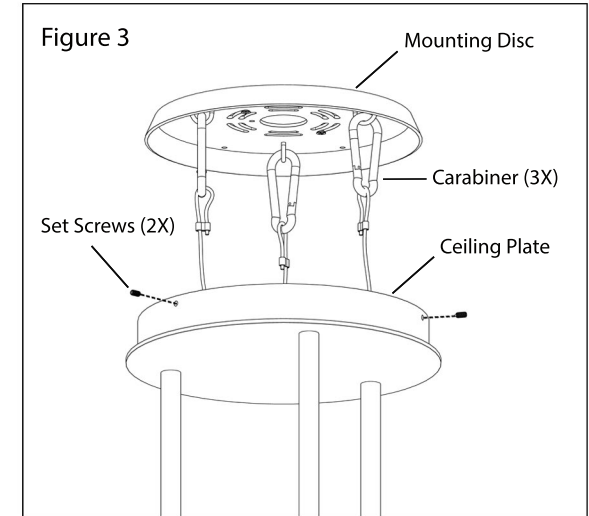

Installation Instructions - Bottom View

Voltaire Mobile Chandelier

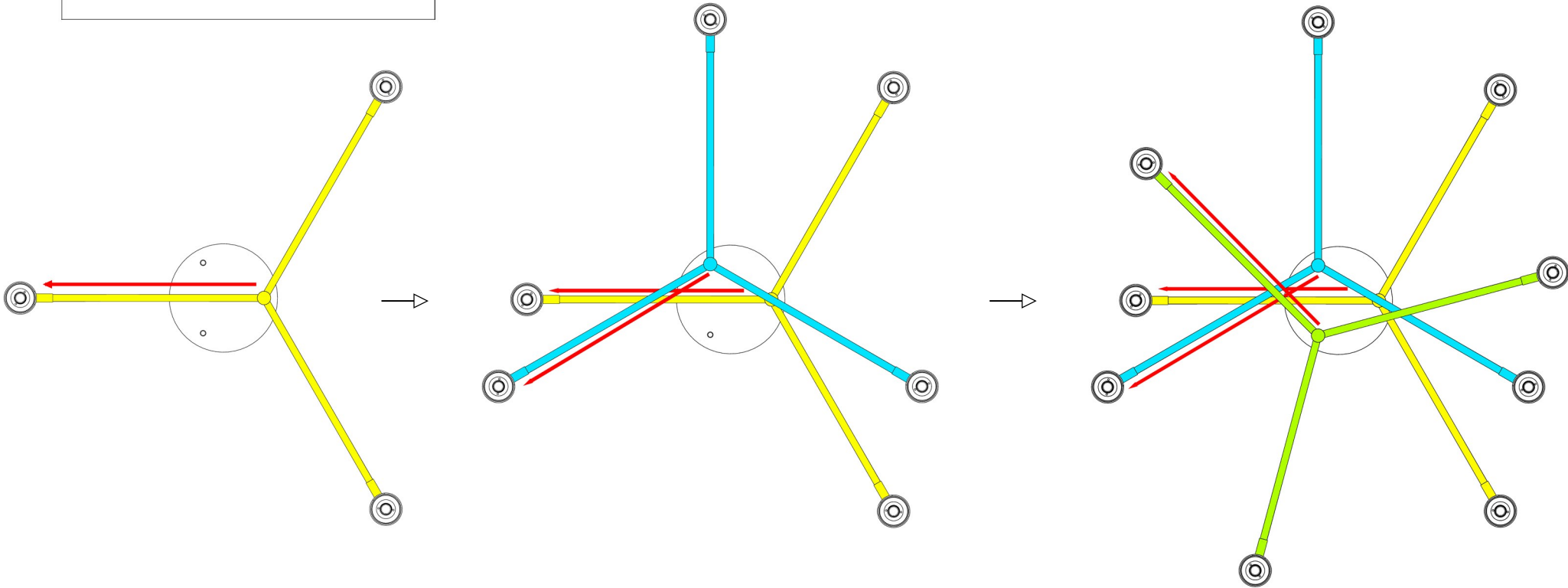
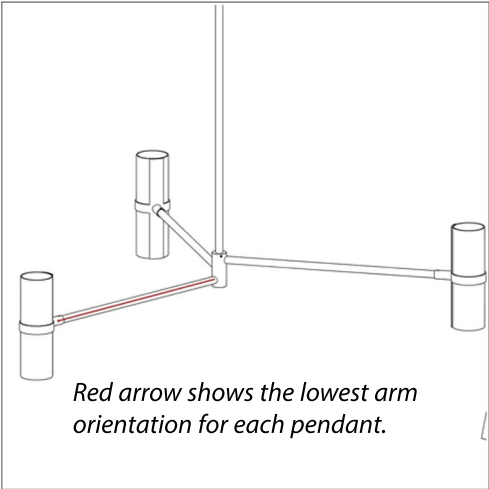

*We recommend installation by a licensed electrician

Electrical: 18 x E12 6W T6 LED bulb only