

# Installation Instructions

Chamont Lavalier

## Important Safety Instructions

- Turn off all power to the Junction Box before making any electrical adjustments.
- Always disconnect the power before installing/replacing bulbs, during cleaning or maintenance.
- To avoid the risk of fire, do not exceed the recommended wattage.
- Consult a qualified, licensed electrician before installation.

## To Assemble

1. Install the beveled mounting disc to the ceiling using the supplied mounting screw hardware (2X).
2. Feed the electrical wires through one of the Drop Rods while inserting the threaded connectors (2X) and Drop Rods (2X) into the Main Body.
3. Insert the threaded connectors (2X) into the Drop Rods and through the Ceiling Plate.
4. Fasten each nut and washer (2X) over the threaded connectors to secure the fixture to the ceiling plate.
5. Hold the pendant near the ceiling and connect the wires from the pendant to those in the J-Box using the supplied wire nuts.
6. Push the Ceiling Plates over the Mounting Discs, flush with the ceiling and tighten all 3 set screws.
7. Screw the bulb into the sockets. \*DO NOT OVERTIGHTEN THE BULBS\*. Place all the shade over the bulb onto the Main Body.
8. Turn on the power to confirm good connections.

## Care Instructions

- Wipe with a soft cloth. Do not use chemical cleaner.

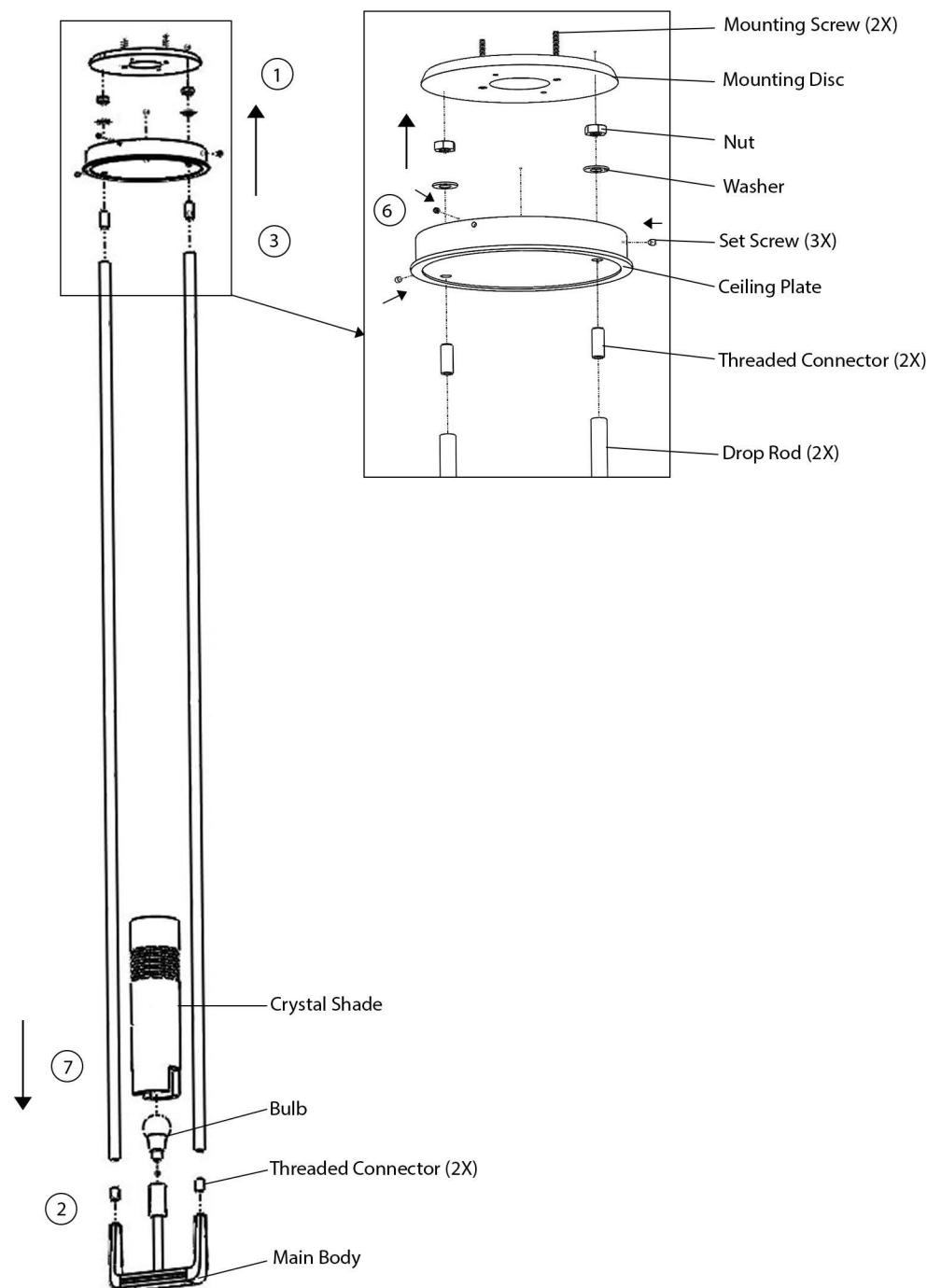

\*We recommend installation performed by a licensed electrician

Electrical: 1 X E12 40W - 60W Max - LED Available