

Installation Instructions

Francaix Pendant

Important Safety Instructions

- Turn off all power to the Junction Box before making any electrical adjustments.
- Always disconnect the power before installing/replacing bulbs, during cleaning or maintenance.
- To avoid the risk of fire, do not exceed the recommended wattage.
- Consult a qualified, licensed electrician before installation.

To Assemble

1. Feed the electrical wires through the Threaded Nipple and slide the Drop Rod over it.
2. Insert the Threaded Nipple into the Body and through the Ceiling Plate.
3. Fasten the nut and washer over the Threaded Nipple to secure the fixture to the ceiling plate.
4. Install the beveled mounting disc to the Junction-Box using the supplied machine screw hardware (2X).
5. Using the supplied wire nuts, connect the wires from the pendant to those in the Junction-Box and slide the ceiling plate+entire fixture over the beveled mounting disc.
6. Tighten each set screw (3X) at the 120° position on the pendant ceiling plate.
7. Install the back crystal on the sconce body and secure it with the top cap. Then, install all the standoffs onto the back crystal and secure them using the caps. Align the front crystal with the back crystal and standoffs and secure it using the remaining caps starting from the top cap as shown in Figure 1. Do not overtighten the cap.
8. Screw in the supplied light bulb.
9. Turn on the power to confirm you have made good wire connections.

Care Instructions

- Wipe with a soft cloth. Do not use chemical cleaner.

*We recommend installation by a licensed electrician

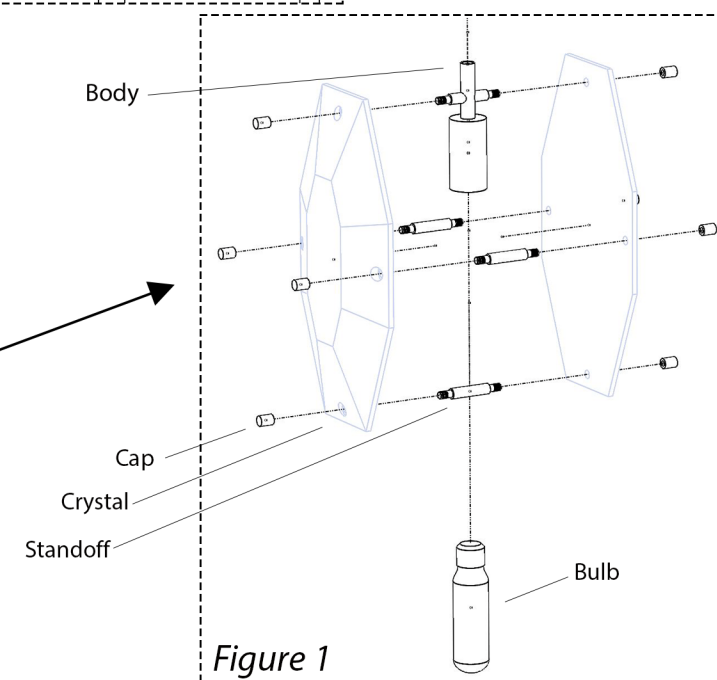
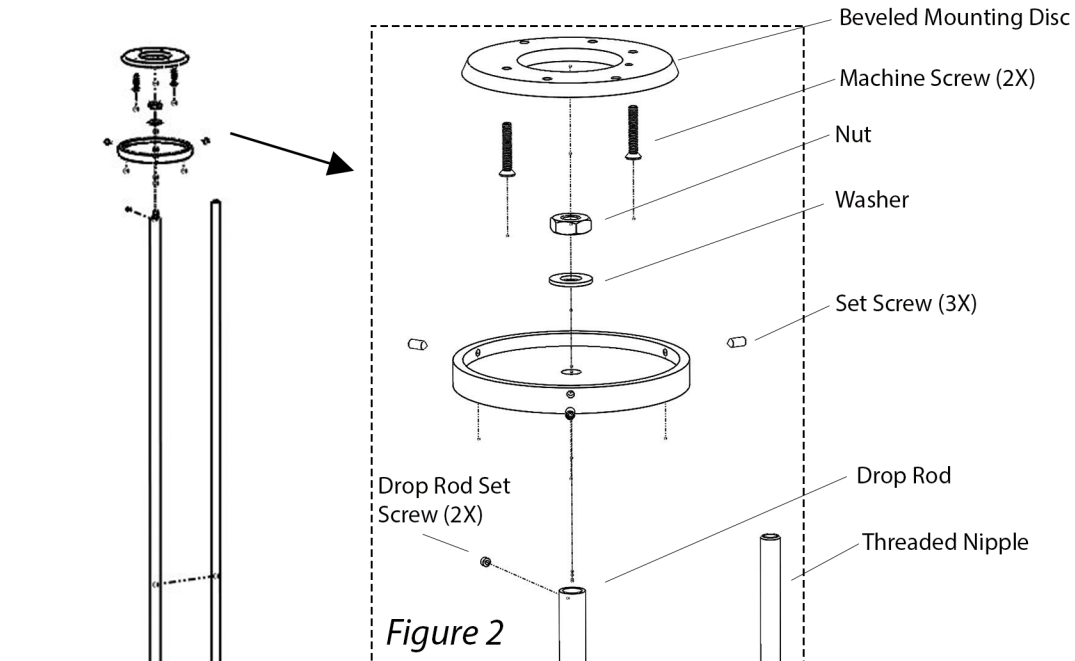

Electrical: 1 x E26 40W - LED Bulb Available