

# Installation Instructions

Ventoux Outdoor Sconce

## Important Safety Instructions

- Turn off all power to the Junction Box before making any electrical adjustments.
- Always disconnect the power before installing/replacing bulbs, during cleaning or maintenance.
- To avoid the risk of fire, do not exceed the recommended wattage.
- Consult a qualified, licensed electrician before installation.

## To Assemble

1. Install the beveled mounting disc to the J-box using the supplied mounting screw hardware (2X).
2. Hold the sconce body next to the J-Box, and connect the wires to those in the J-box using the wire nuts.
3. Remove the set screws at the 12:00 and 6:00 position on the sconce wall plate and press the sconce over the mounting disc, flush with the wall.
4. Level the sconce and tighten the set screw.
5. Slide in the bulb (1X) and place the shade (1X) onto the shade holder.
6. Screw in the Thumb Screw (3X) on the shade holder.
7. Turn on the power to confirm you have made good wire connections.

## Care Instructions

- Wipe with a soft cloth. Do not use chemical cleaner.

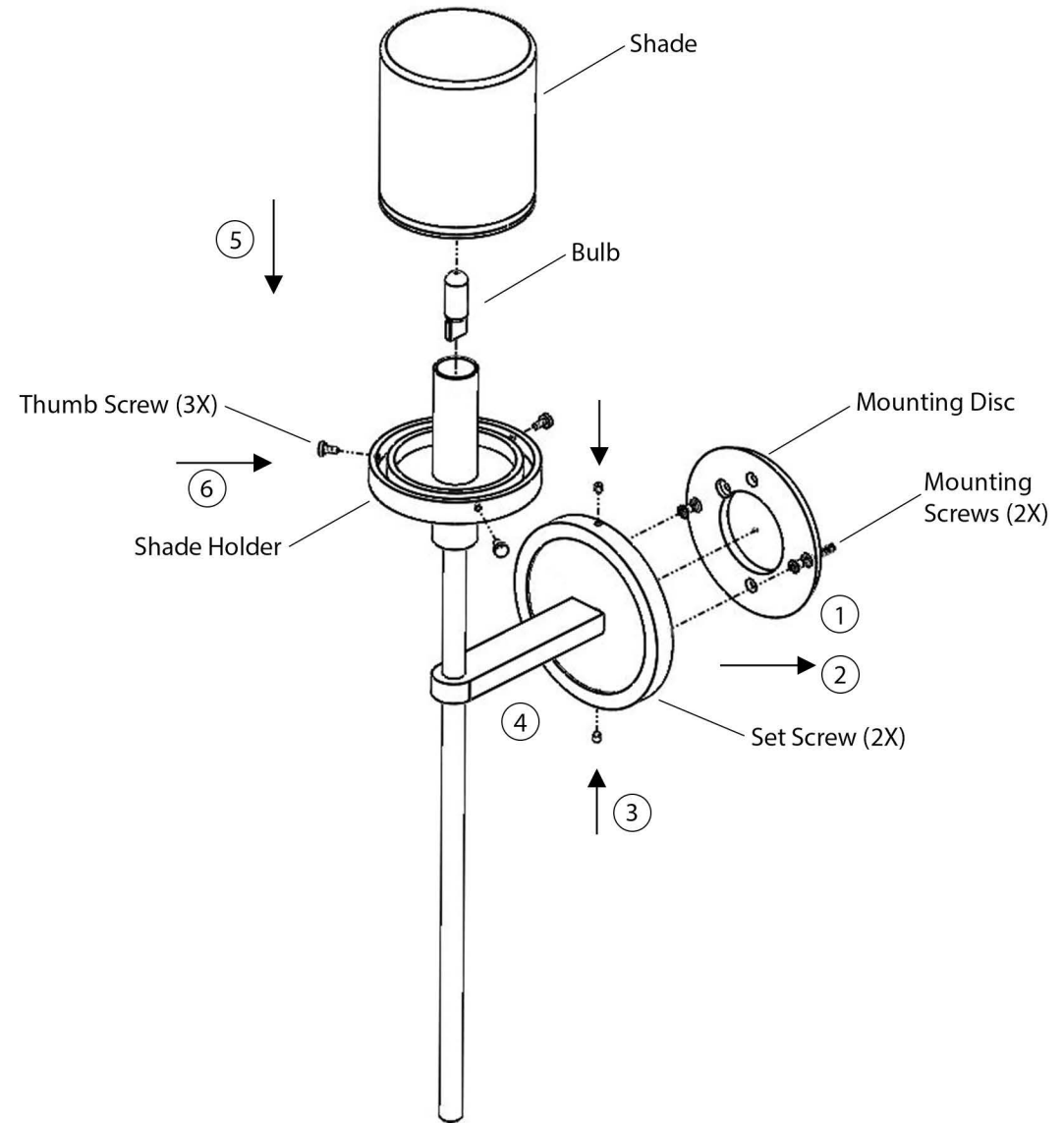

Electrical: 1 x G9 40W - 75W Max - LED Available

\*We recommend installation by a licensed electrician